

**15052 SERIES - BRASS GATE VALVE SWEAT X SWEAT LEAD FREE**

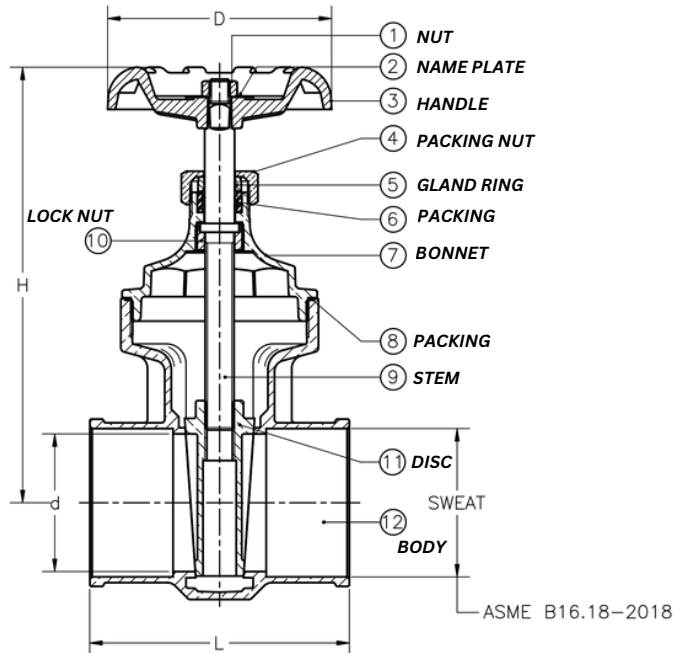
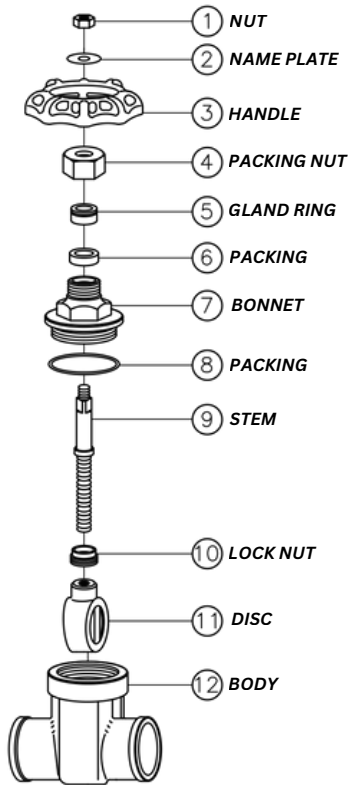

**SPECIFICATION**

LEAD FREE FORGED BRASS  
 SIZE: 1/2" - 4"  
 FULL PORT  
 SWEAT X SWEAT CONNECTION  
 MAX TEMPERATURE RATING MAX: 180°F  
 PRESSURE RATING: 200 PSI WOG  
 NSF/ANSI/CAN 61/372  
 GREEN HANDLE  
 ANSI B1.20.1

**COMPONENTS**

N°	DESCRIPTION	MATERIAL
1	NUT	HOT ROLLED SAE 1010R
2	NAME PLATE	ALUMINUM A1100
3	HANDLE	CAST IRON JIS ZZ2202
4	PACKING NUT	BRASS ROD C37700
5	GLAND RING	BRASS ROD C37700
6	PACKING	RUBBER (NBR) SN-719F
7	BONNET	CAST BRASS C85700
8	PACKING	FIBER
9	STEM	BRASS ROD C37700 (1/4" - 2") CAST BRASS C85700 (2-1/2" - 4")
10	LOCK NUT	BRASS ROD C37700
11	DISC	CAST BRASS C85700
12	BODY	CAST BRASS C85700

**DIMENSIONS**

CODE	SIZE	D	H	L	INCHES
15051-005	1/2"	2.09	2.88	1.69	
15051-007	3/4"	2.13	3.22	2.32	
15051-010	1"	2.48	3.78	2.72	
15051-012	1-1/4"	2.72	4.54	2.93	
15051-015	1-1/2"	3.15	5.07	3.33	
15051-020	2"	3.52	5.88	3.98	
15051-025	2-1/2"	3.98	7.78	4.61	
15051-030	3"	4.37	8.80	5.31	
15051-040	4"	4.84	9.73	6.42	